



**MOVE INN ESTATES**  
MAKING THE RIGHT MOVE



**Waye Avenue**  
Hounslow, TW5 9SD  
Price Guide £525,000



## Floor Plan

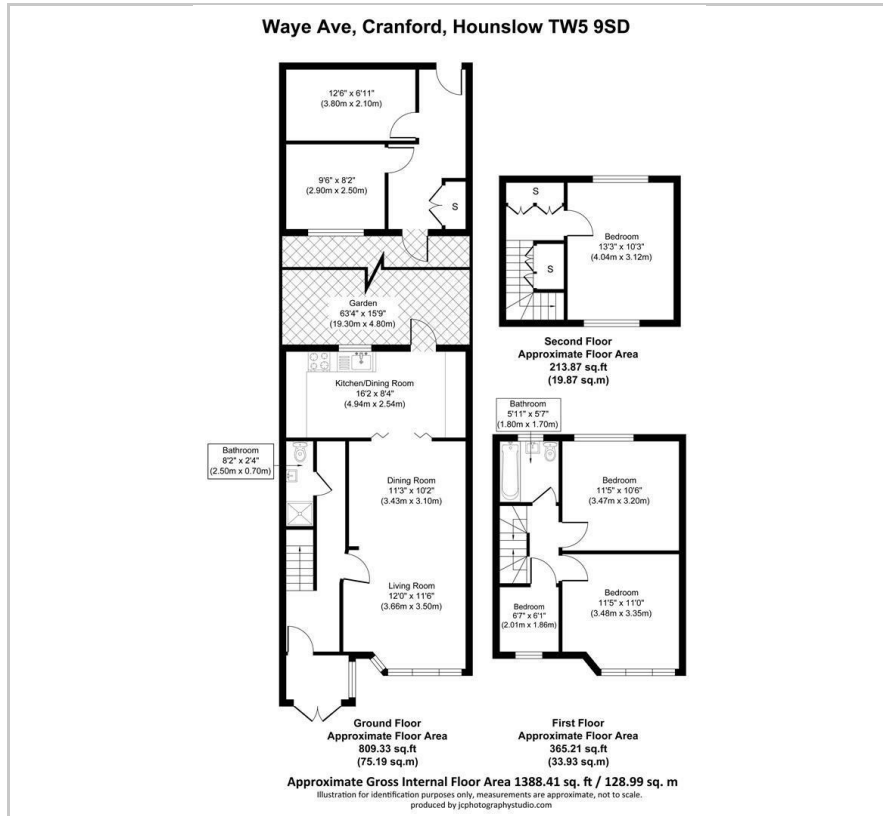

## Area Map



## Energy Efficiency Graph

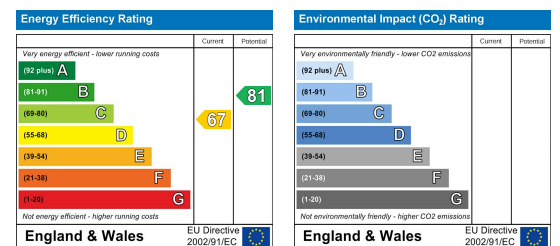

## Viewing

Please contact our Move Inn Estates - Sales Office on 0208 574 4966 if you wish to arrange a viewing appointment for this property or require further information.

- Near Heathrow Airport
- 4 Bedroom Mid Terrace House
- Through lounge
- Rear Extension
- Driveway for 2 cars
- Chain Free

Introducing an exceptional offering from Move Inn Estates: a stunning four-bedroom terraced property located on Waye Avenue, Cranford.

This property comprises an inviting entrance hall, a spacious reception area, and a fully fitted kitchen complemented by a dining area. Boasting four well-sized bedrooms, including a loft extension, and two three-piece bathroom suites, it offers ample living space for comfort and convenience.

Additional benefits include a driveway with space for two vehicles, a serene private garden, and access to an annex for additional storage needs.

Nestled just off Bath Road in Cranford, Waye Avenue enjoys a prime location in close proximity to Heathrow Airport. Convenient access to major motorway links such as the M4/A312/A40 ensures easy connectivity to surrounding areas, as well as a plethora of amenities and shopping facilities.

Don't miss out on this incredible opportunity – call now to schedule a viewing!



These particulars, whilst believed to be accurate are set out as a general outline only for guidance and do not constitute any part of an offer or contract. Intending purchasers should not rely on them as statements of representation of fact, but must satisfy themselves by inspection or otherwise as to their accuracy. No person in this firm's employment has the authority to make or give any representation or warranty in respect of the property.